

AIRFLOW® CORD

UNCLOGGING PROTOCOL

EMS AIRFLOW® cords may become clogged. It usually results from humidity in the air-power channel. To avoid this issue, please always follow EMS' cleaning recommendations.

With the AIRFLOW® Prophylaxis Master, a CLIP + CLEAN accessory is included to ensure ideal daily maintenance.

If you are experiencing clogging issues, please follow the protocol below or scan the QR Code to watch the video.

HOW TO UNCLOG THE AIRFLOW® CORD:



Recommended EMS parts

- ▶ FV-083 – Easy Clean
- ▶ BG-087 – Aspiration tube Ø5 x Ø8 mm
- ▶ DT-020 – 5 ml syringe



1

Fill the syringe with water



2

Connect the tube to the AIRFLOW® Handpiece connector

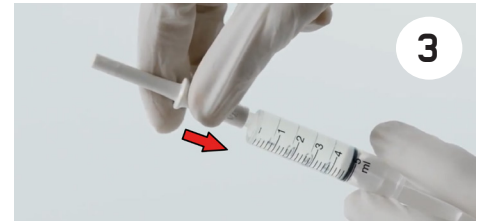

3

Connect the Easy Clean



4

Connect the Easy Clean to the tube



5

Inject water through the AIRFLOW® Hp connector.
Repeat until:
▶ Deposits cease
▶ Flow rate is sufficient

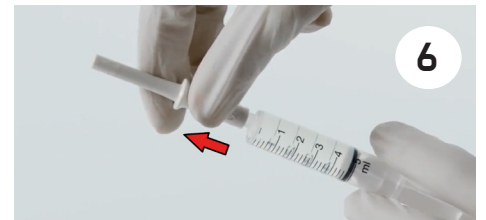

6

Disconnect the syringe from the Easy Clean



7

Fill the syringe with water



8

Connect the syringe to the AIR inlet of the AIRFLOW® cord



9

Inject water through the AIR inlet.
Repeat until:
▶ Deposits cease
▶ Flow rate is sufficient



WATCH
YOUTUBE
VIDEO

EMS+
MAKE ME SMILE.

INTERNAL USE ONLY

AIRFLOW[®] CORD

UNCLOGGING PROTOCOL



10
Fill the syringe with isopropyl alcohol



11
Connect the Easy Clean



12
Connect the Easy Clean to the tube



13
Inject isopropyl alcohol through the AIRFLOW[®] cord connector



14
Disconnect the syringe from the Easy Clean



15
Fill the syringe with isopropyl alcohol



16
Connect the syringe to the AIR inlet of the AIRFLOW[®] cord



17
Inject isopropyl alcohol through the AIR inlet



18
Blow dry air
▶ min 1 minute
▶ max air pressure: 5.0 bar



19
Blow dry air
▶ min 1 minute
▶ max air pressure: 5.0 bar



20
Store the AIRFLOW[®] cord at room temperature for 24h before use



WATCH
YOUTUBE
VIDEO

EMS⁺
MAKE ME SMILE.

INTERNAL USE ONLY



HEADQUARTERS

CH

NYON, SWITZERLAND

ELECTRO MEDICAL SYSTEMS SA
Chemin de la Vuarpillière 31
CH - 1260 Nyon
www.ems-dental.com/en/contact
www.ems-dental.com
T. +41 22 994 47 00
F. +41 22 994 47 01



WORLDWIDE EMS AFFILIATES

DE

MUNICH, GERMANY

EMS ELECTRO MEDICAL SYSTEMS GMBH
Stahlgruberring 12
DE - 81829 München
T. +49 89 42 71 61 0
F. +49 89 42 71 61 60
E-mail: info@ems-ch.de

FR

FONCINE, FRANCE

EMS ELECTRO MEDICAL SYSTEMS FRANCE SARL
32, route de Pontarlier
FR - 39460 Foncine-le-Haut
T. +33 3 84 51 90 01
F. +33 3 84 51 94 00
E-mail: info@ems-france.fr

ES

MADRID, SPAIN

EMS ELECTRO MEDICAL SYSTEMS ESPAÑA SLU
C/ Tomás Bretón, 50-52 2ª planta
ES - 28045 Madrid
T. +34 91 528 99 89
E-mail: info@ems-espana.com

PT

LISBON, PORTUGAL

EMSPOR - ELECTRO MEDICAL SYSTEMS PORTUGAL, UNIPESSOAL LDA
Avenida Miguel Bombarda, 36, 6A
PT - 1050-165 Lisboa
T. +351 912 338 777
E-mail: info@ems-portugal.com

IT

MILANO, ITALY

EMS ITALIA S.R.L
Via Carlo Pisacane 7B
IT - 20016 Pero (MI)
T. +39 02 3453 8111
E-mail: dental@ems-italia.it

UK

CAMBRIDGESHIRE, UNITED KINGDOM

EMS UK LTD SUITE 2
Xenus House - Sandpiper Court
Phoenix Park - Eaton Socon
UK - St Neots, Cambridgeshire
PE19 8EP
T. +44 01480 587260
Email: info@ems-unitedkingdom.com

SE

STOCKHOLM, SWEDEN

EMS NORDIC AB
Hammarby Fabriksväg 61
SE - 120 30 Stockholm
T. +46 8 899 102
E-mail: info@ems-nordic.se

PL

KATOWICE, POLAND

EMS POLAND SP. Z O.O.
Al. Roździeńskiego 188H
PL - 40-203 Katowice
T. +48 32 4937060
E-mail: info@ems-poland.com

JO

AMMAN, JORDAN

EMS ELECTRO MEDICAL SYSTEMS JORDAN
No.2 - second floor, 195 Arar (Wadi Saqra) str.
JO - Amman

US

DALLAS, USA

EMS CORPORATION
11886 Greenville Avenue, Ste 120
US - Dallas, Texas 75243
T. +001 972 690 8382
F. +001 972 690 8981
E-mail: info@ems-na.com

AU

SYDNEY, AUSTRALIA

EMS OCEANIA PTY LTD
The Woolstores - Suite 3, Shed 73
4E Huntley Street
AU - Alexandria, NSW 2015
T. +61 467 774 329
E-mail: service@ems-oceania.com

JP

TOKYO, JAPAN

E.M.S. JAPAN KK
Eminent Ningyouchō Bld 6F,
9-18, Kobuna-cho, Nihombashi
JP - Chuo-ku, Tokyo, 103-0024
T. +81 (0) 3-6810-9351
F. +81 (0) 3-6810-9352
E-mail: emsjapan@ems-ch.com

CN

SHANGHAI, CHINA

医迈斯电子医疗系统贸易(上海)有限公司
E.M.S. ELECTRO MEDICAL SYSTEMS TRADING (SHANGHAI) CO., LTD.
24A, Jin Sui Mansion,
N°379 Pudong Nan Rd.
CN - Shanghai 200120
T. +86 21 3363 2323
E-mail: emschina@ems-ch.com

KR

SEOUL, SOUTH KOREA

EMS ELECTRO MEDICAL SYSTEMS KOREA LTD.
13, Beobwon-ro 8-gil, Songpa-gu
T. +82 70 7807 2875
E-mail: emskorea@ems-ch.com